

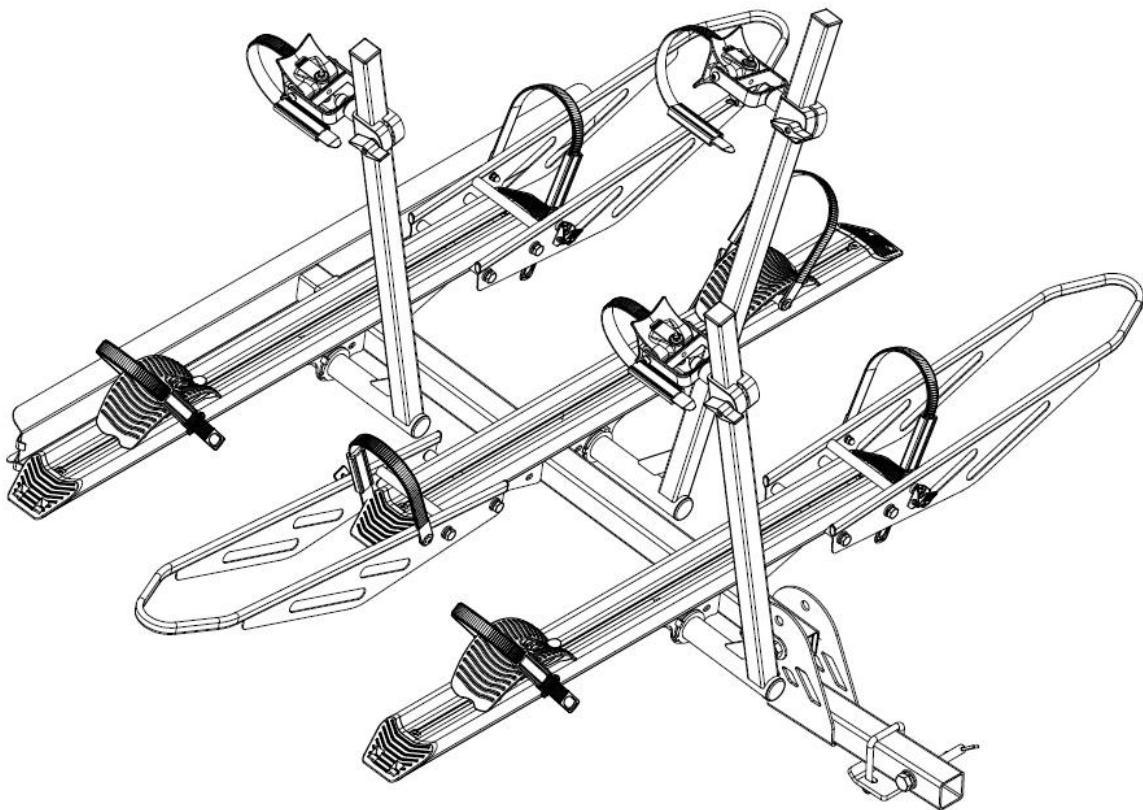

250LBS.FOLDABLE ALUMINUM 3-EBIKE

CARRIER WITH RAMP

SKU:10104156



Technical Specifications

Property	Specification
Length	68"
Width	55.5"
Height	40"
Maximum Weight Capacity	250LBS

Parts List

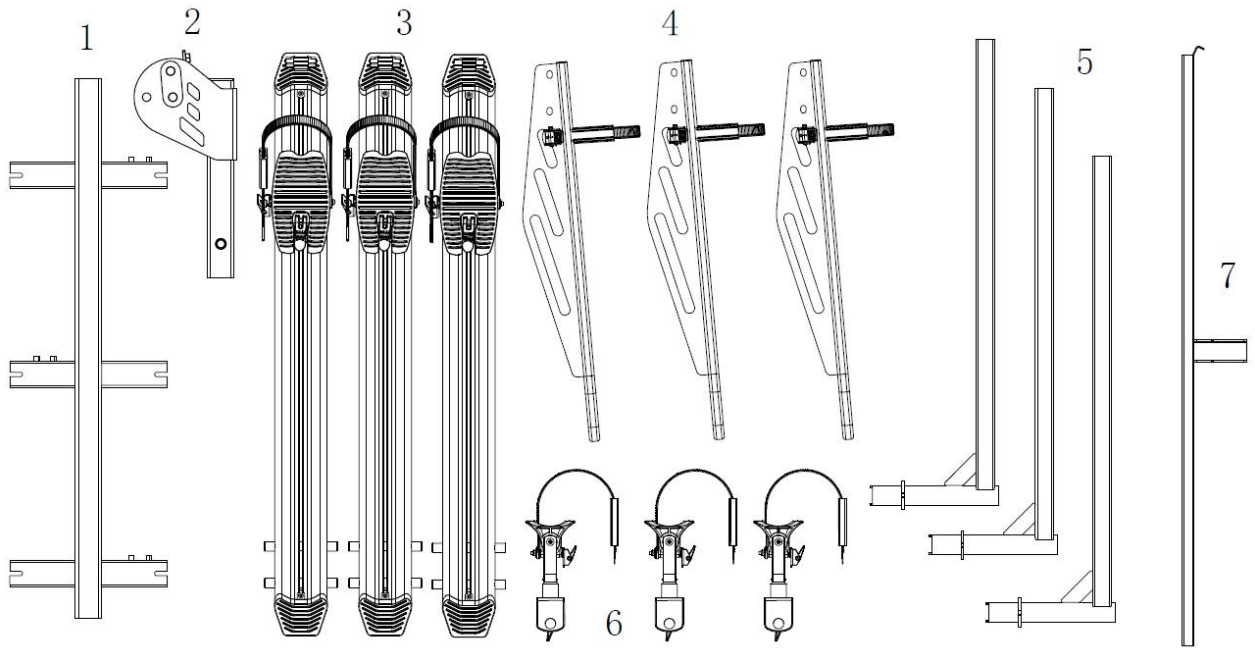

8



9



10

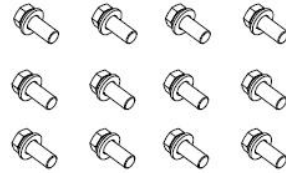

11



12



13



14



15



16

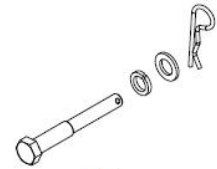

17

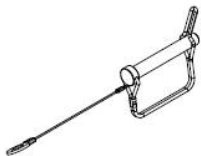

18

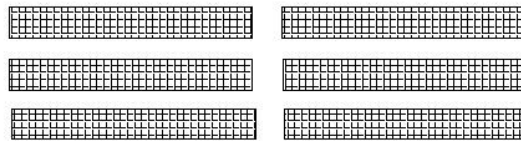

19



20

Recommended Tools for Assembly (Not Included)



Monkey Wrench (1pc)
Size=300mm



Open Wrench (1pc)
Size=13mm



Open Wrench (1pc)
Size=17mm



Open Wrench (1pc)
Size=24mm

Assembly Instructions

Step 1:

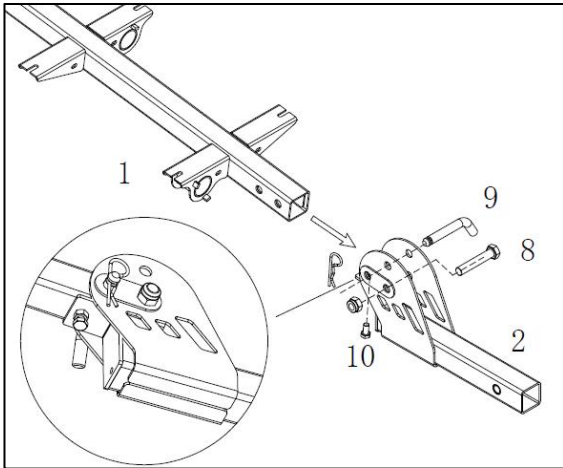

STEP2:

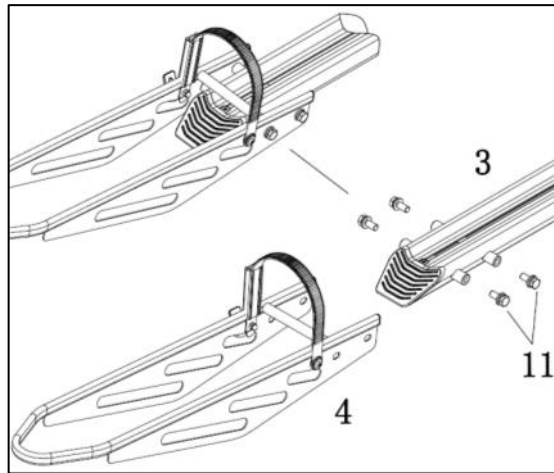

Step 3:

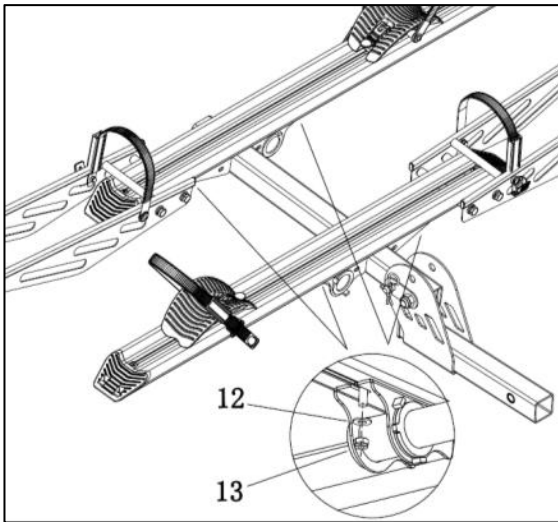

STEP4:

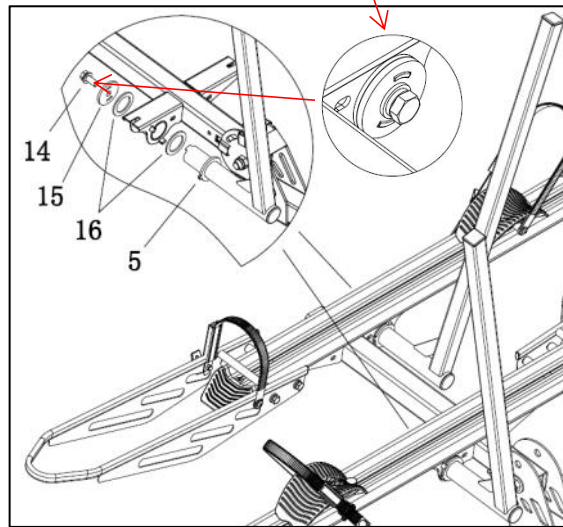

Step 5:

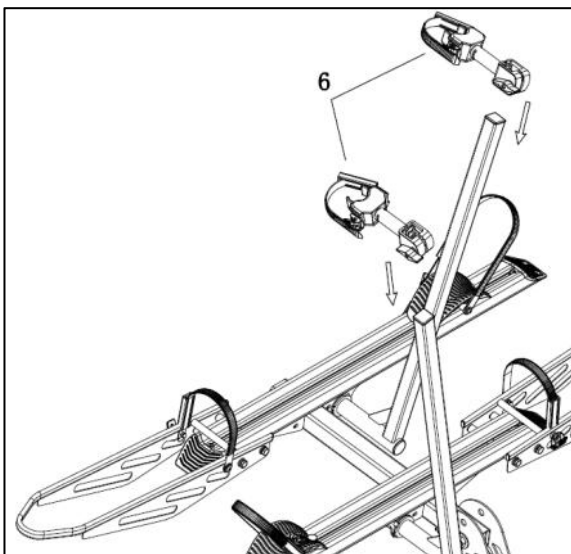

STEP6:

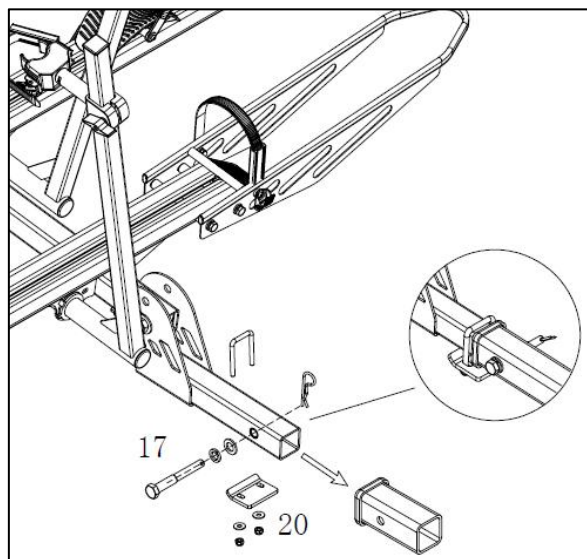

STEP7 : Ramp Instruction

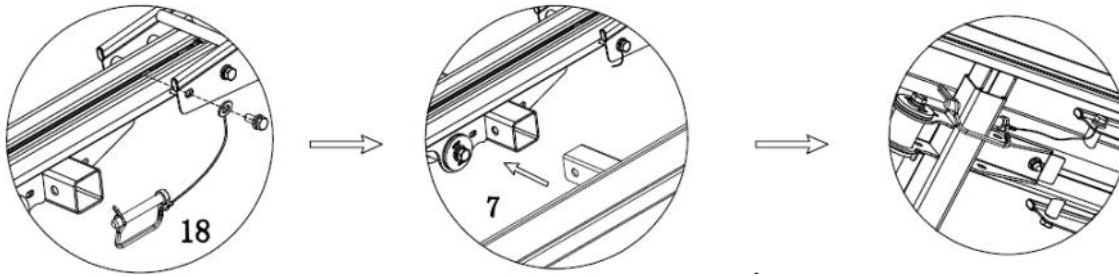

Bike Installation Instructions (Second bike rack and Third bike rack in the same step)

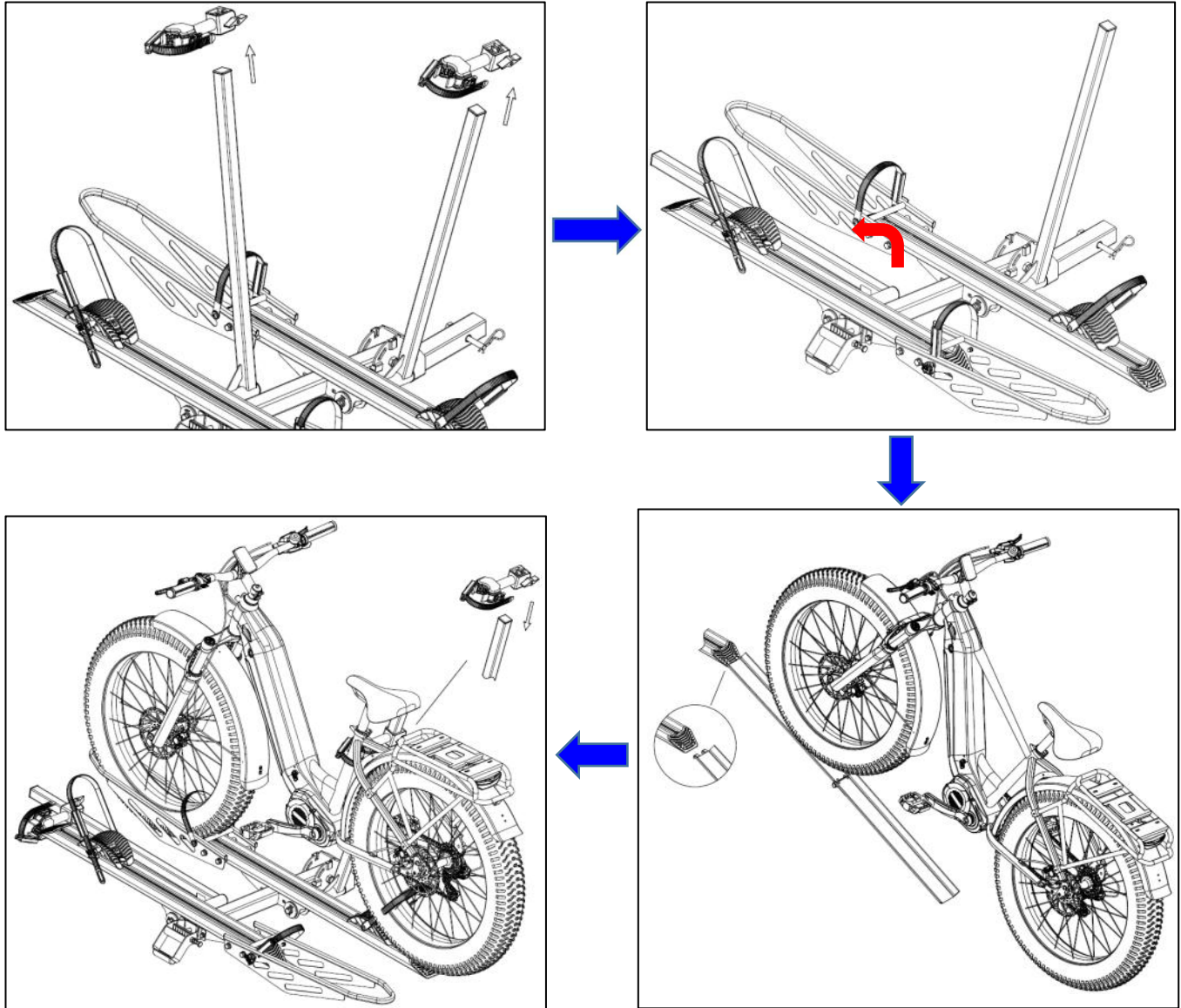

2A. How to secure the wheel cradle.

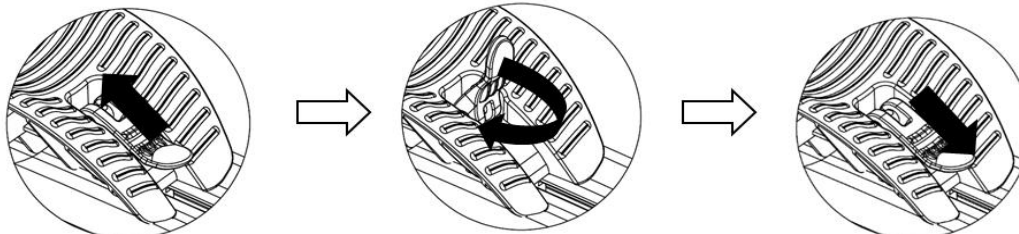

Pull the cam gear

Turn it clockwise

Press it down

2B. How to release the wheel cradle.

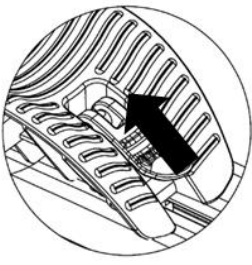

Pull the cam gear

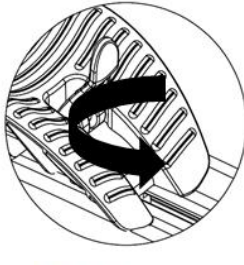

Turn it
Counterclockwise

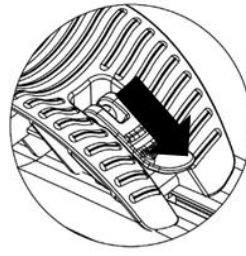

Press it down

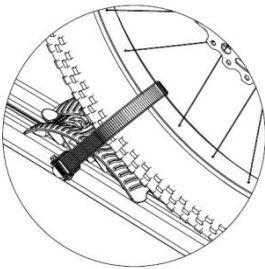
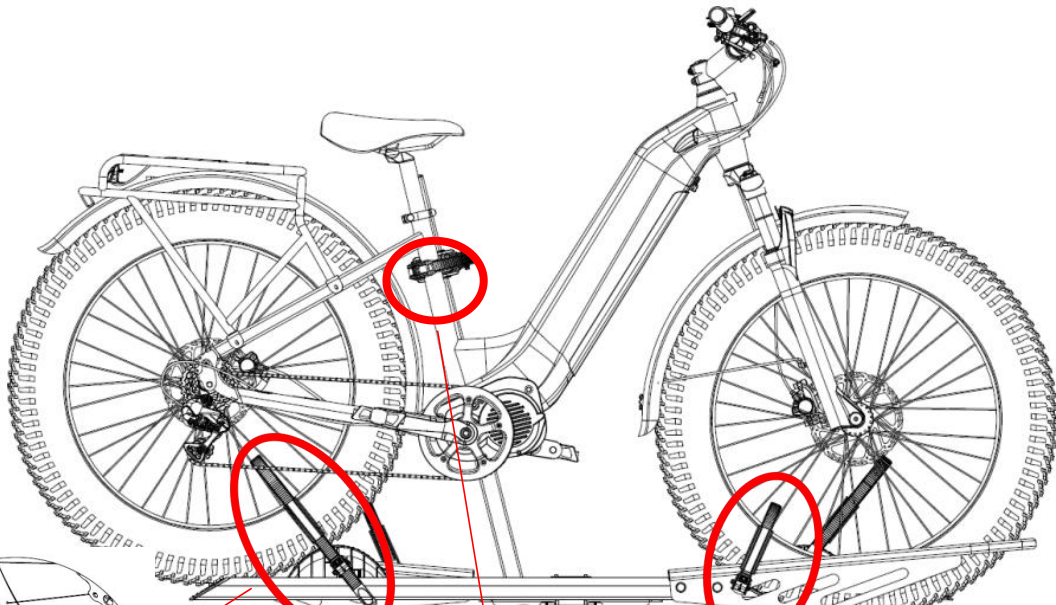

Note: The rear tire fixing seat needs to be placed in front of the rear wheel.

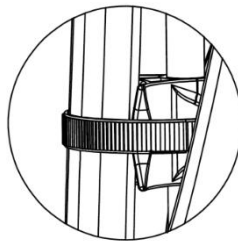

Note: Tighten the straps from the Adjustable Block.

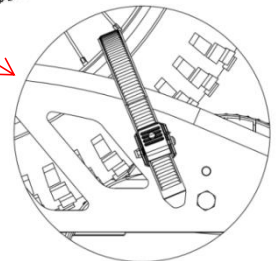

Note: Tighten the straps from the Front Wheel Holder. Use of narrow tires up to 3" requires serial part 19 adhesive tape for way fixing.

Folding Status

Part 6 adjustable support assembly needs to be placed on the bottom of the aluminum beam and secured with part 19 adhesive tape.

