

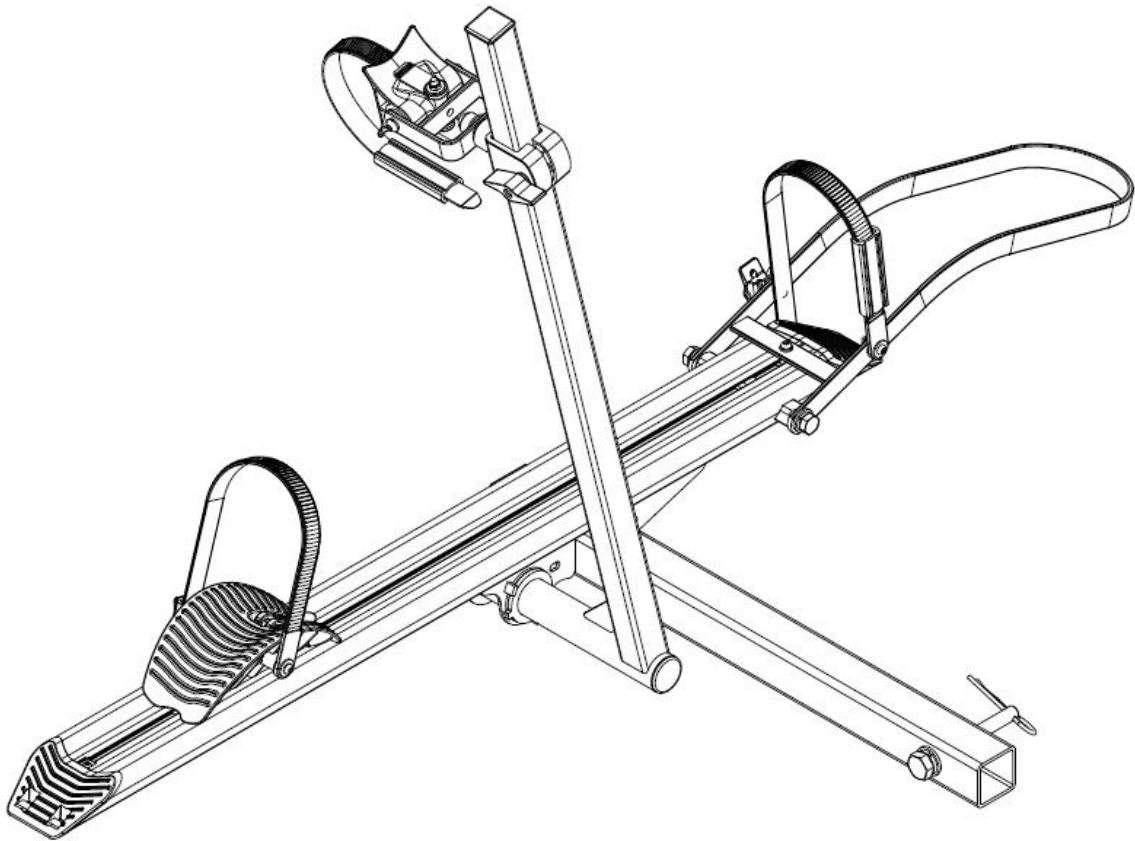

100LBS. ALUMINUM 1-EBIKE CARRIER

10104154



Technical Specifications

Property	Specification
Length	57"
Width	26"
Height	33.5"
Maximum Weight Capacity	100LBS

Parts List

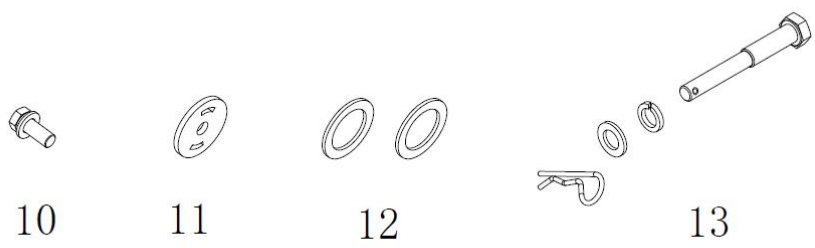
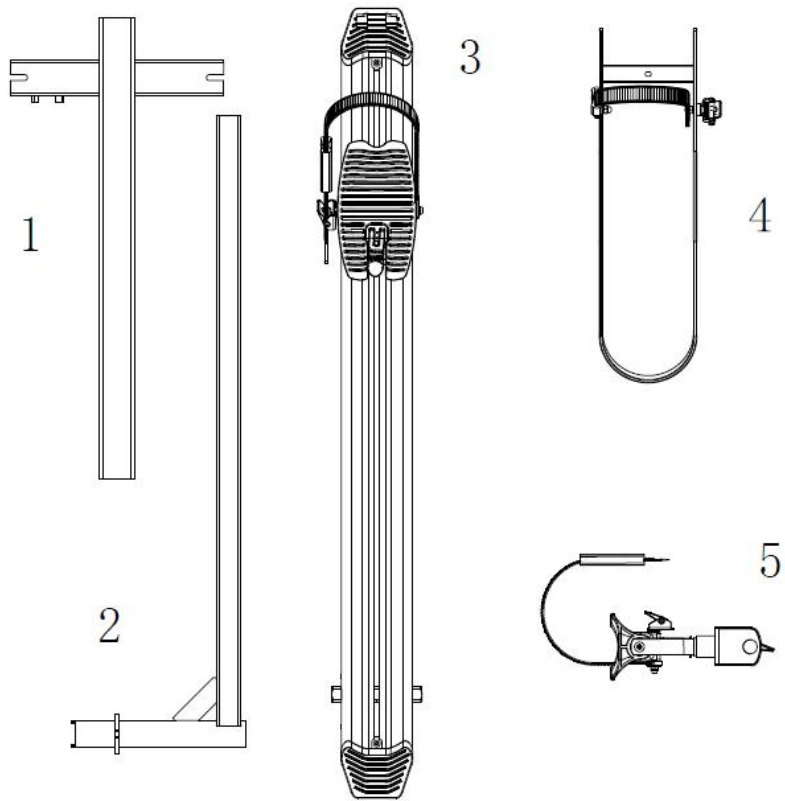

Recommended Tools for Assembly (Not Included)



Monkey Wrench (1pc)
Size=300mm



4mm Allen Wrench(1pc)



Open Wrench (1pc)
Size=19mm



Open Wrench (1pc)
Size=24mm

Assembly Instructions

Step 1:

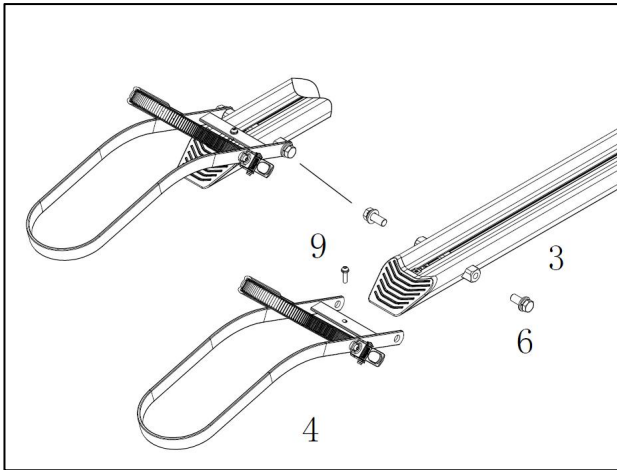

STEP2:

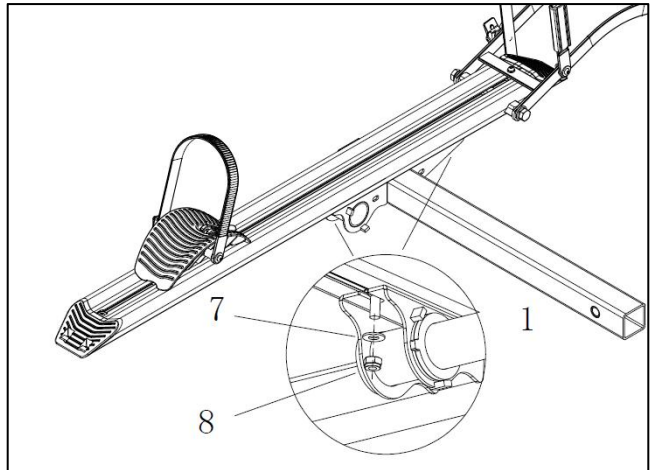

Step 3:

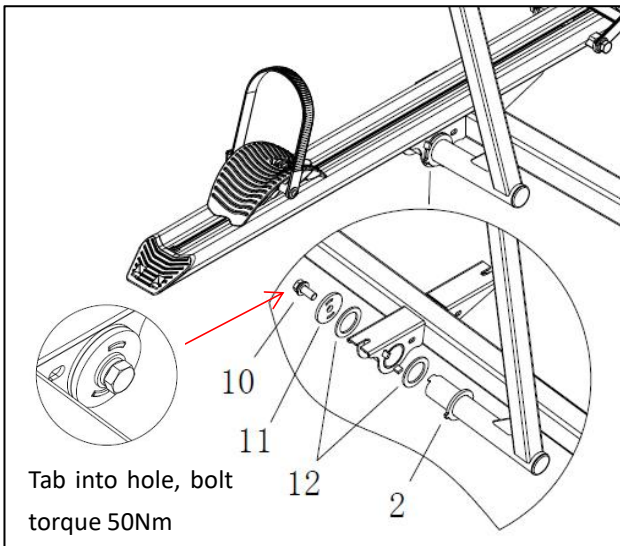

STEP4:

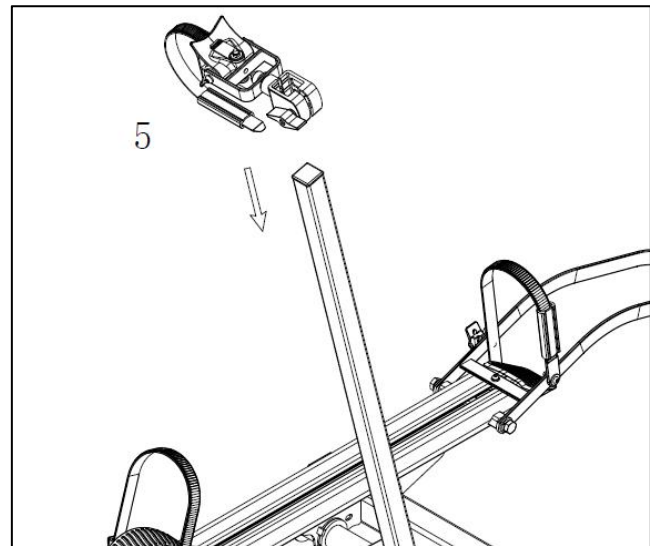

Step 5:

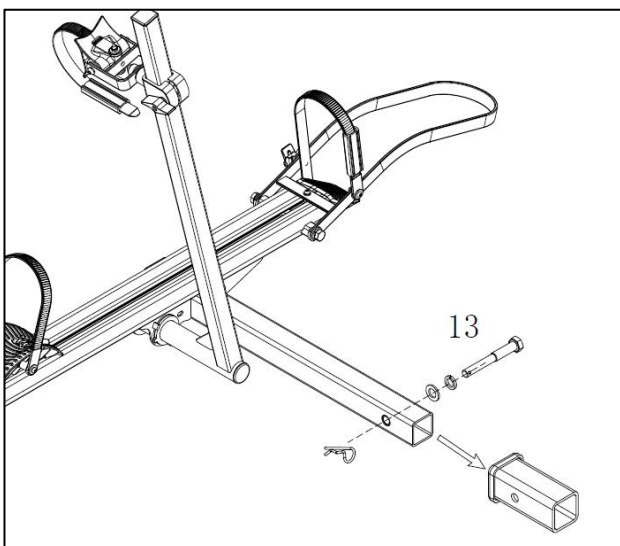

Bike Installation Instructions

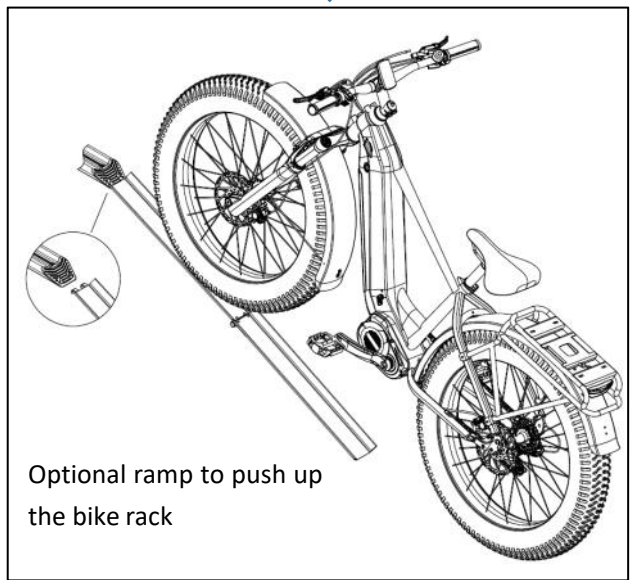
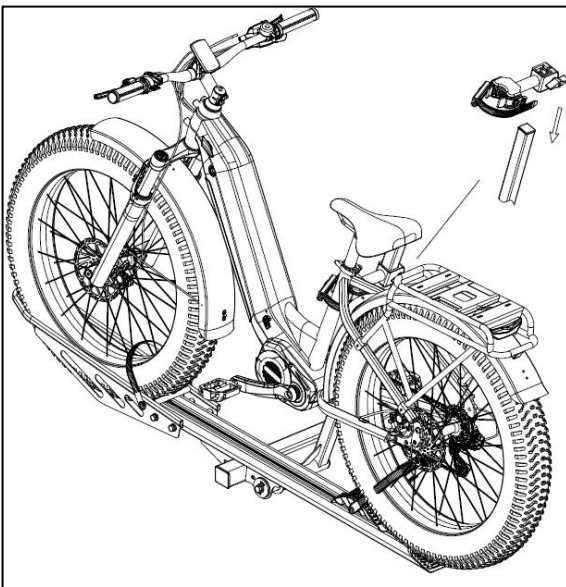
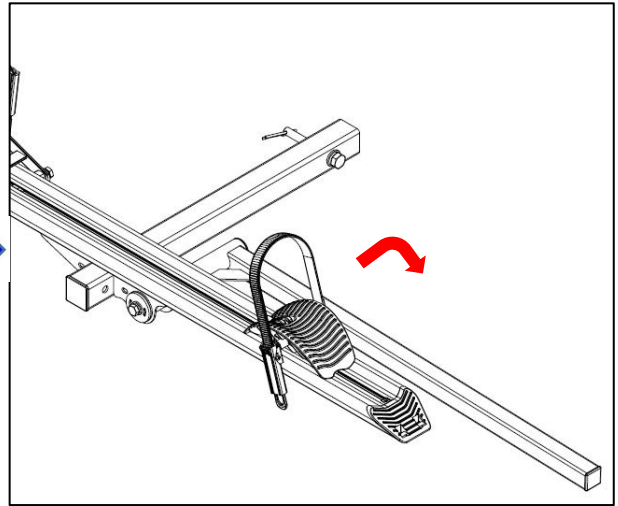
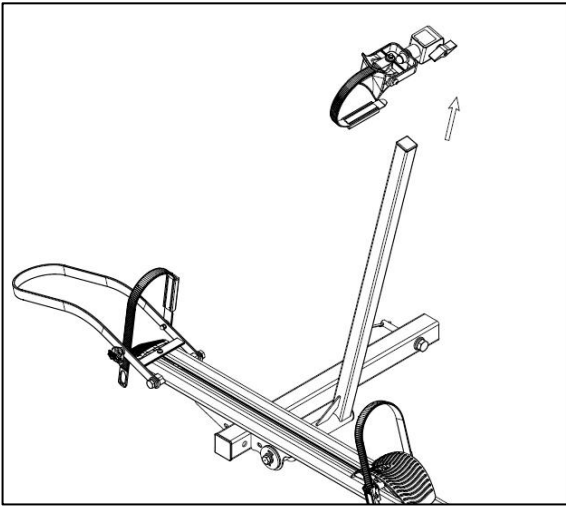

2A. How to secure the wheel cradle.

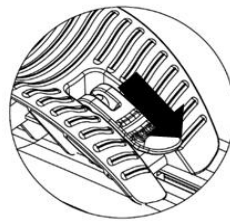
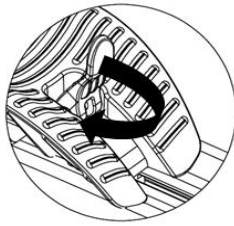
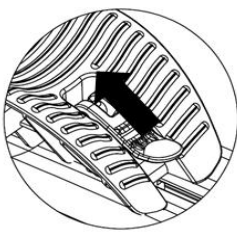

Pull the cam gear

Turn it clockwise

Press it down

2B. How to release the wheel cradle.

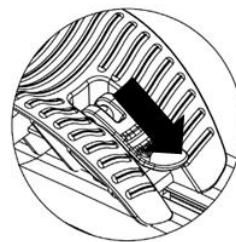
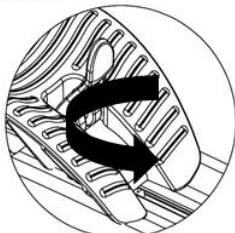
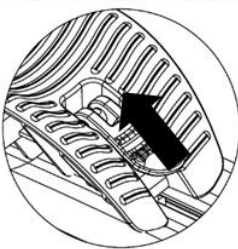

Pull the cam gear

Turn it
Counterclockwise

Press it down

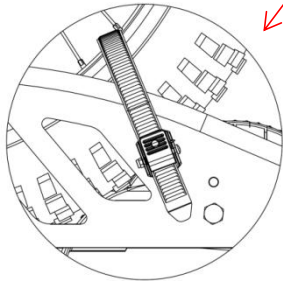
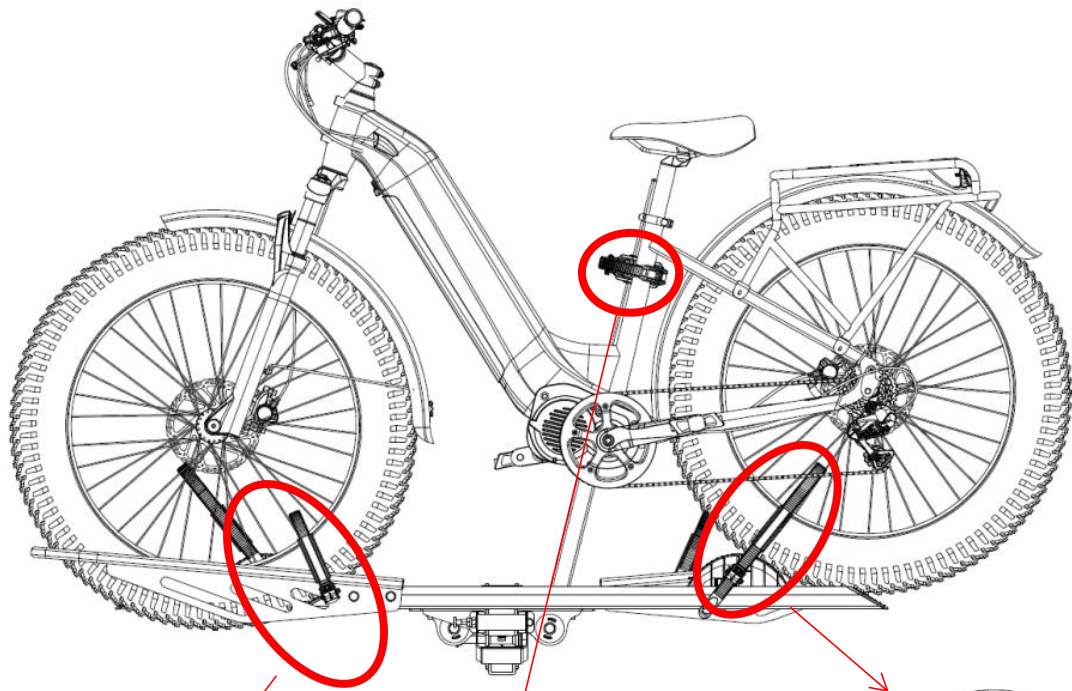

Note: Tighten the straps from the Front Wheel Holder.

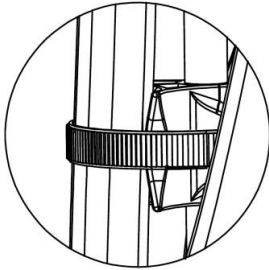

Note: Tighten the straps from the Adjustable Block.

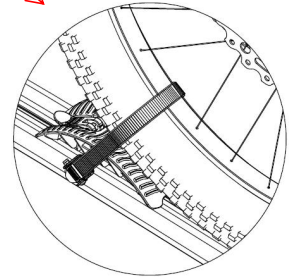

Note: The rear tire fixing seat needs to be placed in front of the rear wheel.