

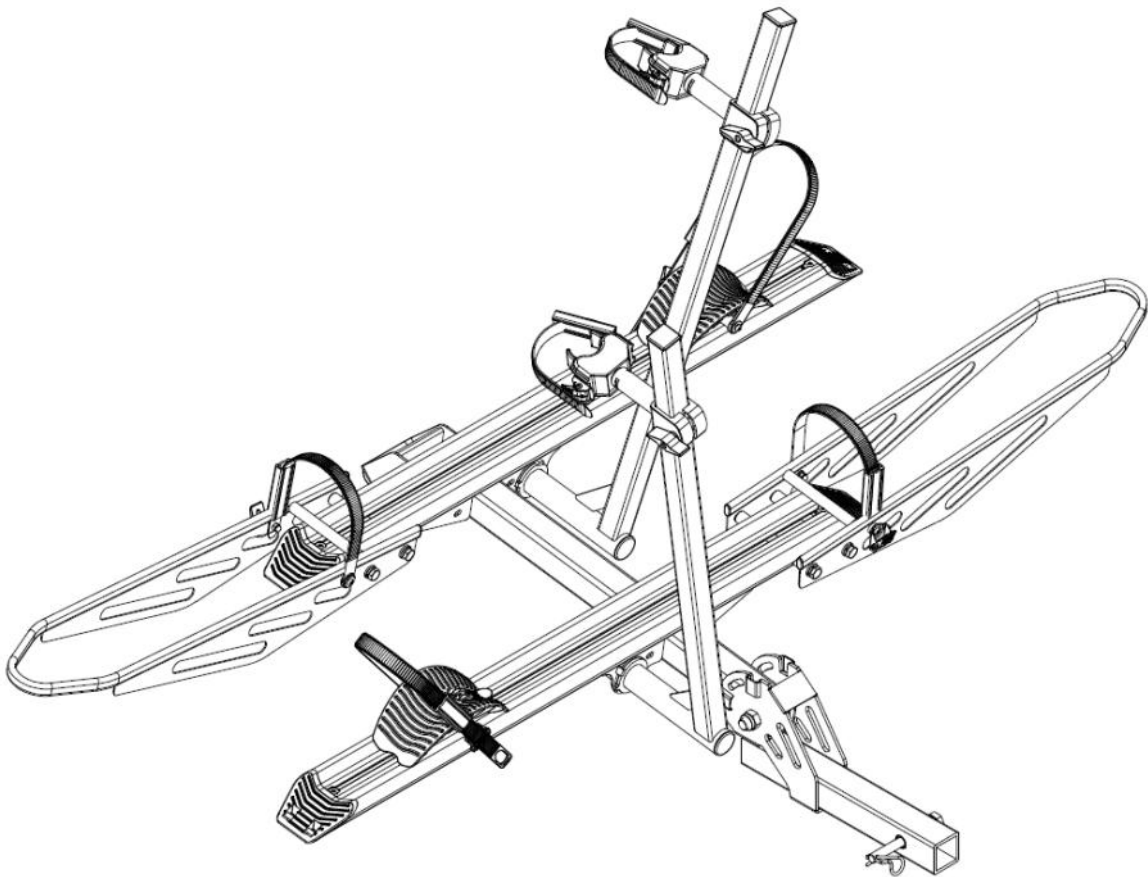

## **EZ-Fold 2-Bike Rack without Ramp**

**ITEM:10104147**



**MANUAL**

# Technical Specifications

Property	Specification
Length	71.5"
Width	43.5"
Height	40"
Maximum Weight Capacity	200LBS

## Parts List

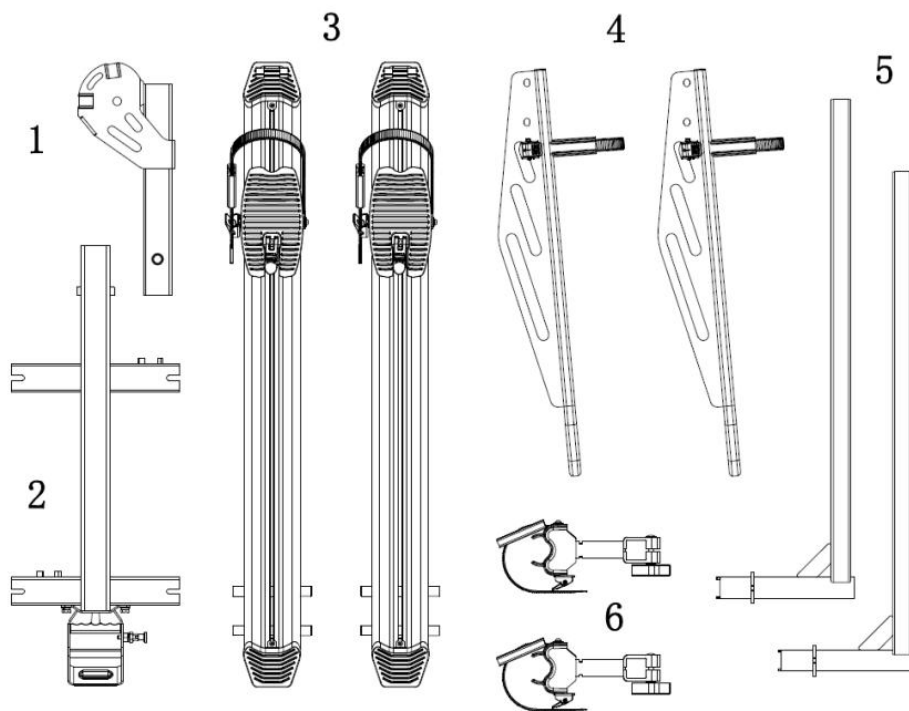

7

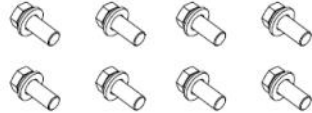

8



9



10



11



12



13

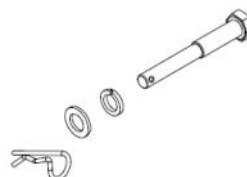

14



15

## Recommended Tools for Assembly (Not Included)



Monkey Wrench (1pc)  
Size=300mm



Open Wrench (1pc)  
Size=17mm



Open Wrench (1pc)  
Size=19mm



Open Wrench (1pc)  
Size=24mm

## Assembly Instructions

Step 1:

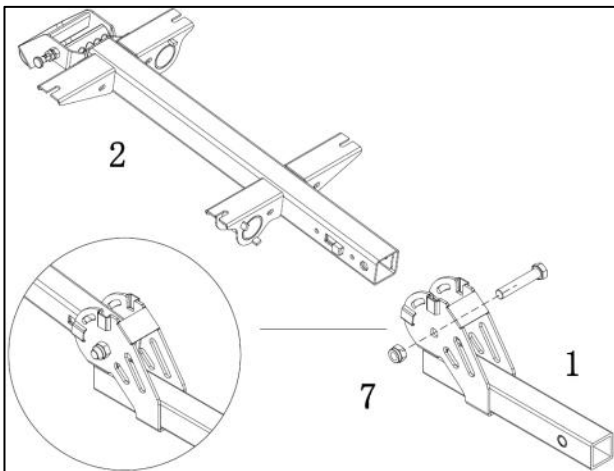

STEP2:

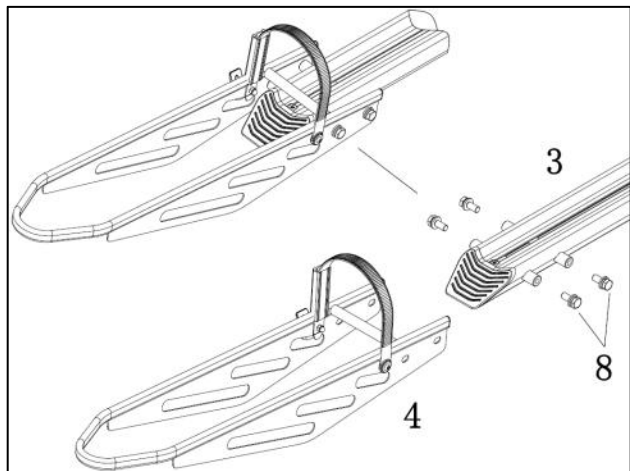

Step 3:

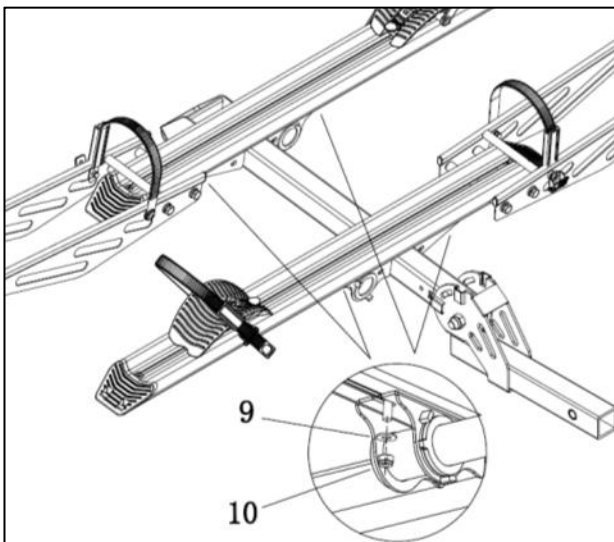

STEP4:

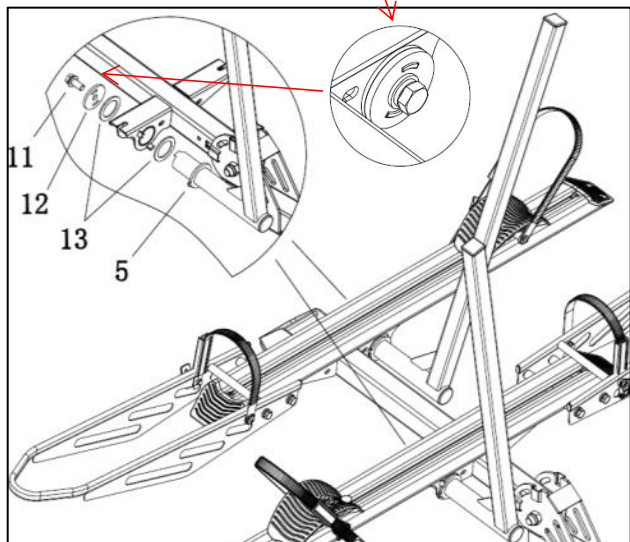

The boss is put into the hole,  
and the bolt torque is 50Nm.

Step 5:

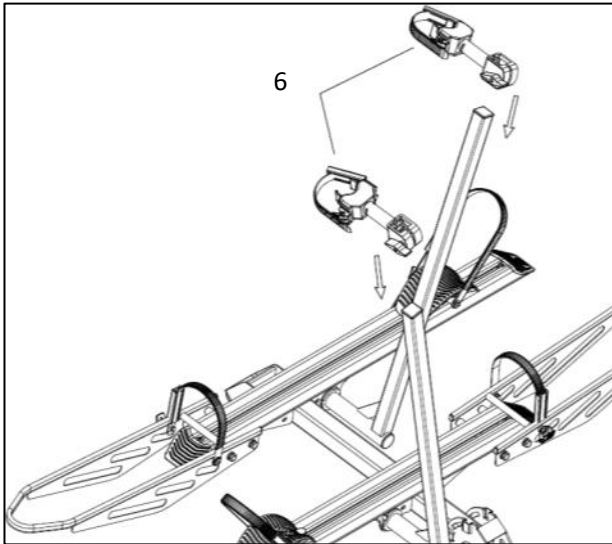

STEP6:

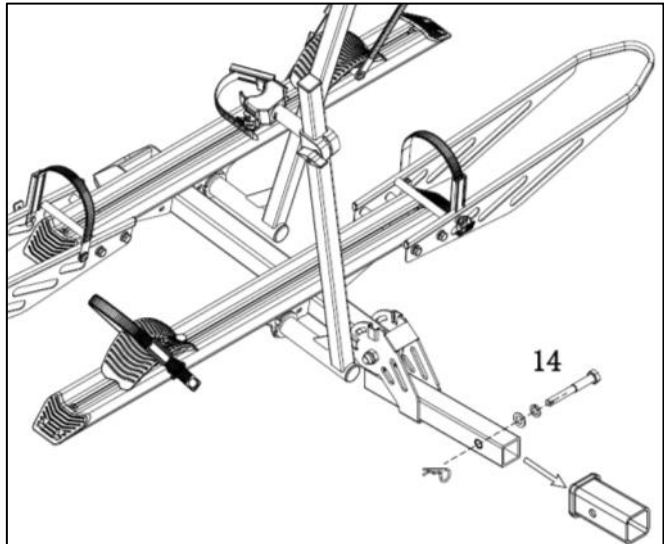

### Bike Installation Instructions (Second car same step)

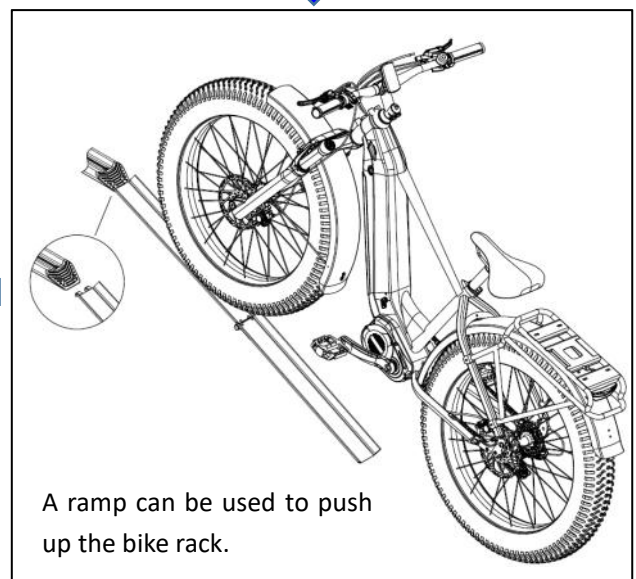
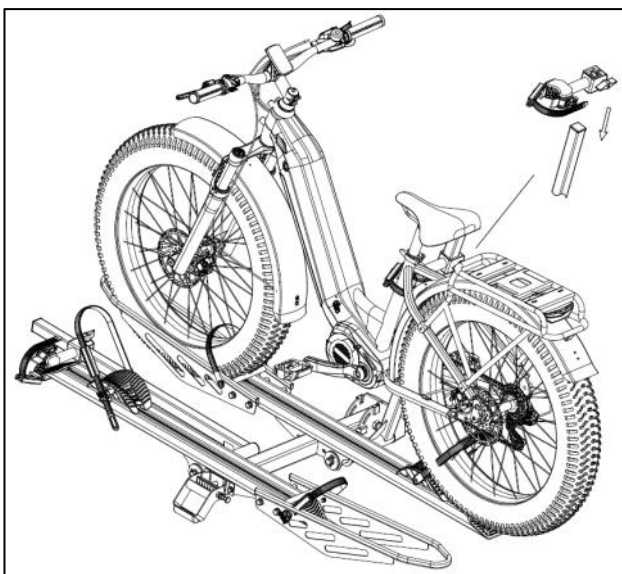
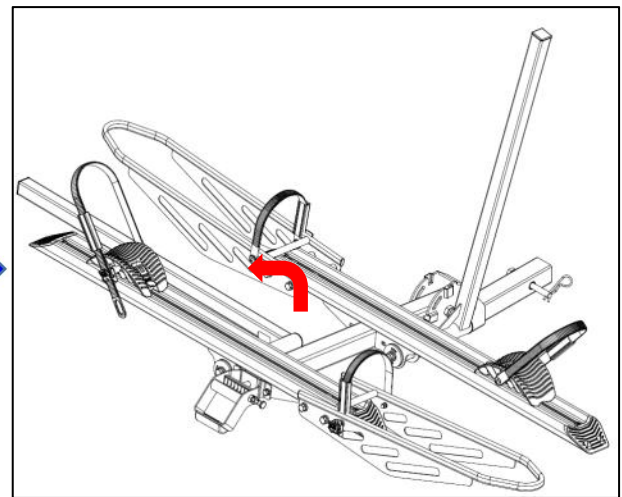
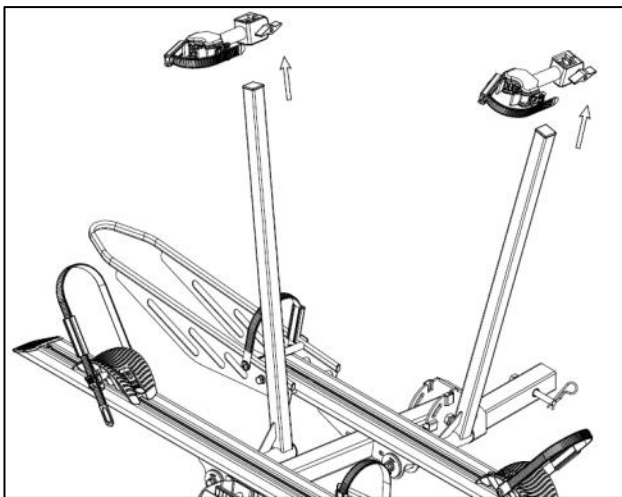

2A. How to secure the wheel cradle.

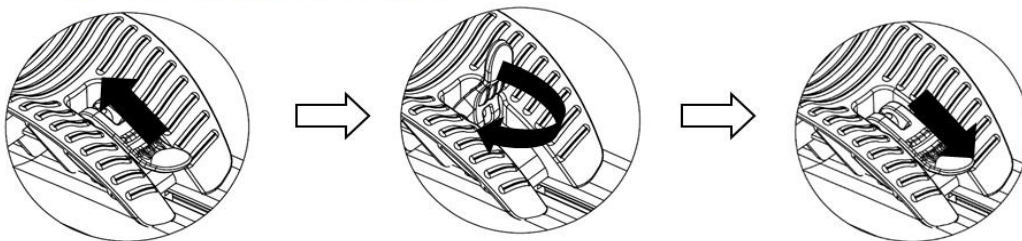

Pull the cam gear

Turn it clockwise

Press it down

2B. How to release the wheel cradle.

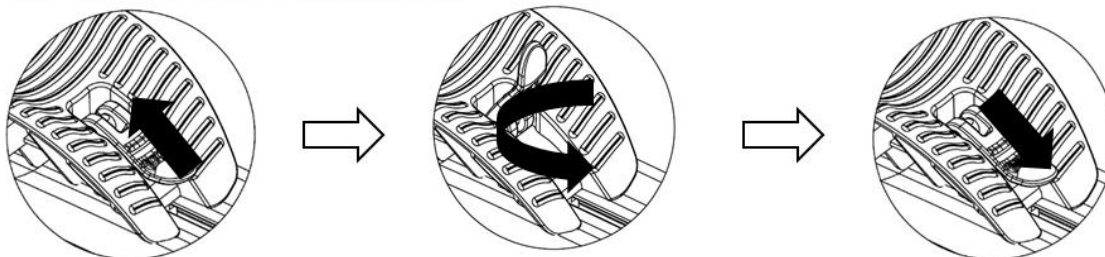

Pull the cam gear

Turn it  
Counterclockwise

Press it down

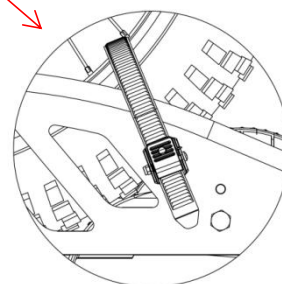
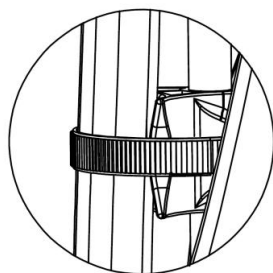
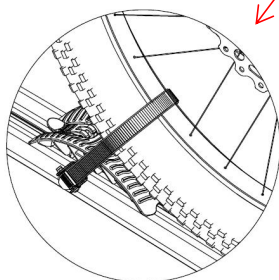
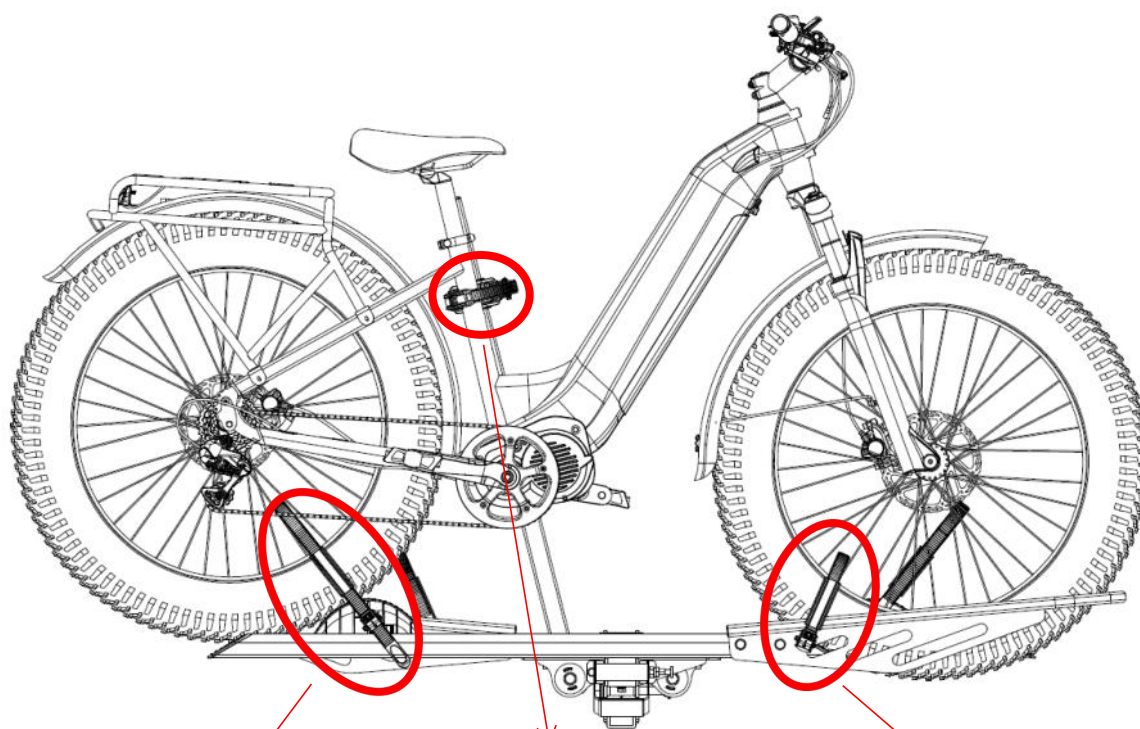

Note: The rear tire fixing seat needs to be placed in front of the rear wheel.

Note: Tighten the straps from the Adjustable Block.

Note: Tighten the straps from the Front Wheel Holder. The use of narrow tires within 3 "requires serial number 15 tape fixation

## Folding Status

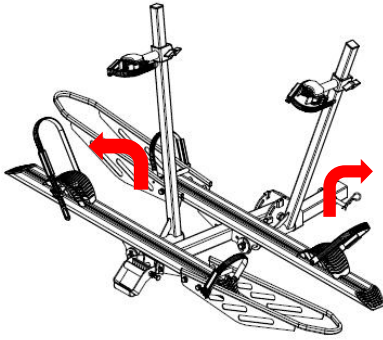

No. 6 The adjustment support assembly must be placed at the bottom of the aluminum beam and secured with No. 15 adhesive tape

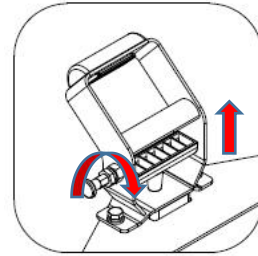
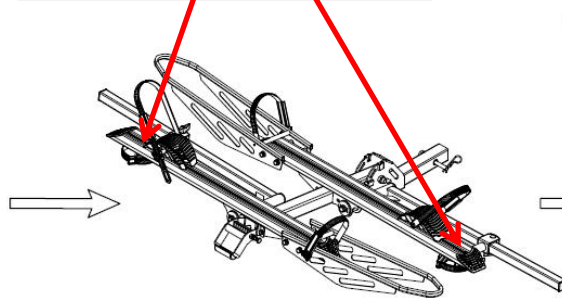

Note: Before pulling the handle to fold it needs to be pull out the limit pin on the side and rotate it 90°.

